

Workstations in clinical labs and life sciences are designed to meet the stringent requirements of medical research, diagnostics, and life sciences investigations. These workstations provide a controlled environment for various analytical procedures, ensuring accuracy, sterility, and adherence to regulatory standards.

Our adept design team comprehends the intricacies of your working environment, having collaborated with numerous prominent industrial, research, educational, and government facilities. We specialize in curating workstations that encompass the ideal combination of features, options, and accessories tailored to meet the unique demands of your tasks.

The Workplace<sup>®</sup> product line, known for its versatility, offers a myriad of layout possibilities, each meticulously crafted to fulfill specific requirements. These designs not only establish a robust foundation for a lifetime of reliable service but also boast adaptability, ensuring they can be easily retrofitted to accommodate evolving needs in the future.



### Ready to get started? We Are.

Conceptual drawings, and detailed cost quotes are provided on a no-obligation basis. Visit our website or contact a Design Specialist today for more details.

**workplacenh.com**  
**sales@workplacenh.com**  
**800.258.9700**





## Life Science Bio Tech Lab | LD-046

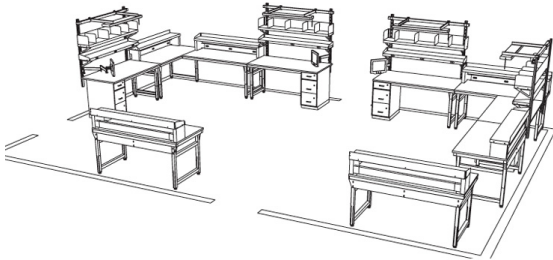

Overtable shelf storage was an important requirement for this application. Varying storage needs were met with a combination of fixed riser shelves, adjustable overtable shelves with back and end stops, and adjustable overtable divider shelves.

## Microbiology Lab | LD-055

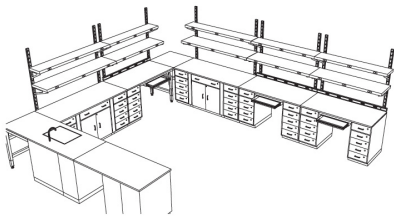

Extensive storage needs in a Biology Lab were easily met with Series 7000 cabinet components and adjustable overtable shelves. Powerstrips, keyboard trays, and a sink complete this layout

## Microscope Table | LD-061

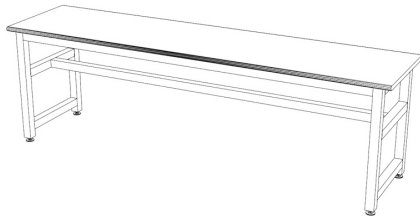

A two-sided microscope table was configured with a customized Series 4500 table for a hospital requirement. The 24"Dx96"L unit is manually adjustable in height from 30" up to 37".

## Field Division Table | LD-057



A test and repair unit utilizes a Series 4500 mobile table with post-formed plastic laminate top. The unit is equipped with several optional accessories, including an adjustable overtable divider shelf on double Standard Uprights, and articulating arm, metal safety shield, keyboard tray, and three tiered drawer cases.



## Biology | LD-006

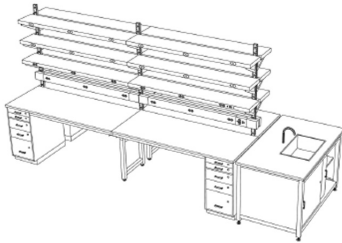

Series 7000 in-line Technician Station rows are located back-to-back. Center leg supports are recessed for optional use of workspace. Options include adjustable overtable shelves and wiretroughs. A Series 6600 Lab unit with sink and sliding doors complete the area.

## Nuclear Test Lab | LD-045

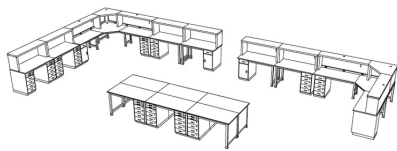

This Series 6700 Mobile Lab station, available in several standard sizes, was selected for an HPLC application. The requirement was met with Model N3114 and N3116 drawer cases.

## Metallurgy Lab | LD-023

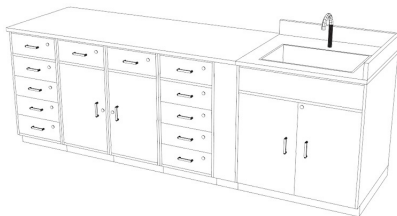

An in-line row of Series 7000 cabinets, including two with hinged doors, are paired with a double cabinet which includes a sink. Resin tops were selected for this work station, with optional back and end splash for sink unit. Row measures 30"Dx15"Lx36"H.

## DNA Sequencing | LD-054

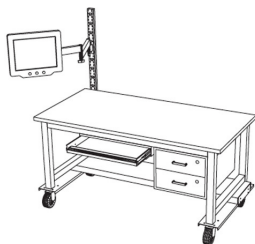

A flat screen articulating arm, keyboard tray, and Model N3114 drawer case accessorize a Series 4500 Mobile table for use in a DNA sequencing application.

## HPLC Table | LD-053



The Series 6700 Mobile Lab Station, available in several standard sizes, was selected for an HPLC application. The requirement for drawer storage was met with Model N3114 and N3116 drawer cases.

## Science Lab | LD-026

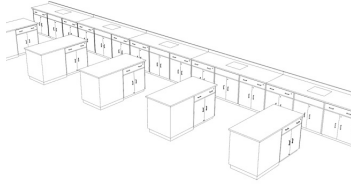

A full wall of Series 7000 double cabinet features a sink in each group of 3 units. Each Island Station is designed with two double cabinets facing opposite directions, to configure a spacious two-worker workstation with ample storage.

## Molecular Biology Lab | LD-047

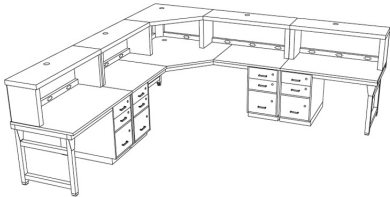

A Series 5300 Quad unit fits this corner requirement perfectly. Additional work space is provided with the addition of Series 7000 Technician Station components to the right and left of corner unit. Fixed riser shelves and powerstrips provide needed storage and power.

## HIV Lab | LD-049

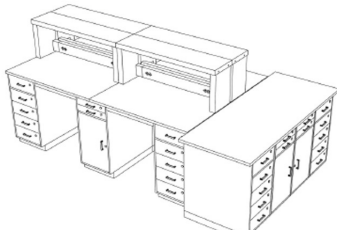

Maximizing available lab space, two distinct work environments were designed with the Series 7000 modular components. Two in-line rows of Cabinet-to-Cabinet stations are positioned back-to-back, while a banked corner of four cabinets is located perpendicular to the in-line rows.